

CERTIFICATE OF LOCATION OF GOVERNMENT CORNER

North Quarter _____ Corner of Section 28, Township 112N, Range 18W, 5th P.M.

STATE OF MINNESOTA, County of Goodhue

At the corner location shown on the sketch:

- On _____ found a _____
DATE _____
 left monument as found, lowered monument, removed monument (explain)
- On 5-1-75 placed a Goodhue County Cast Iron Monument down 1/2" in
DATE _____ bituminous road (T.H. 19).

SKETCH OF REFERENCE TIES
SECTION 21

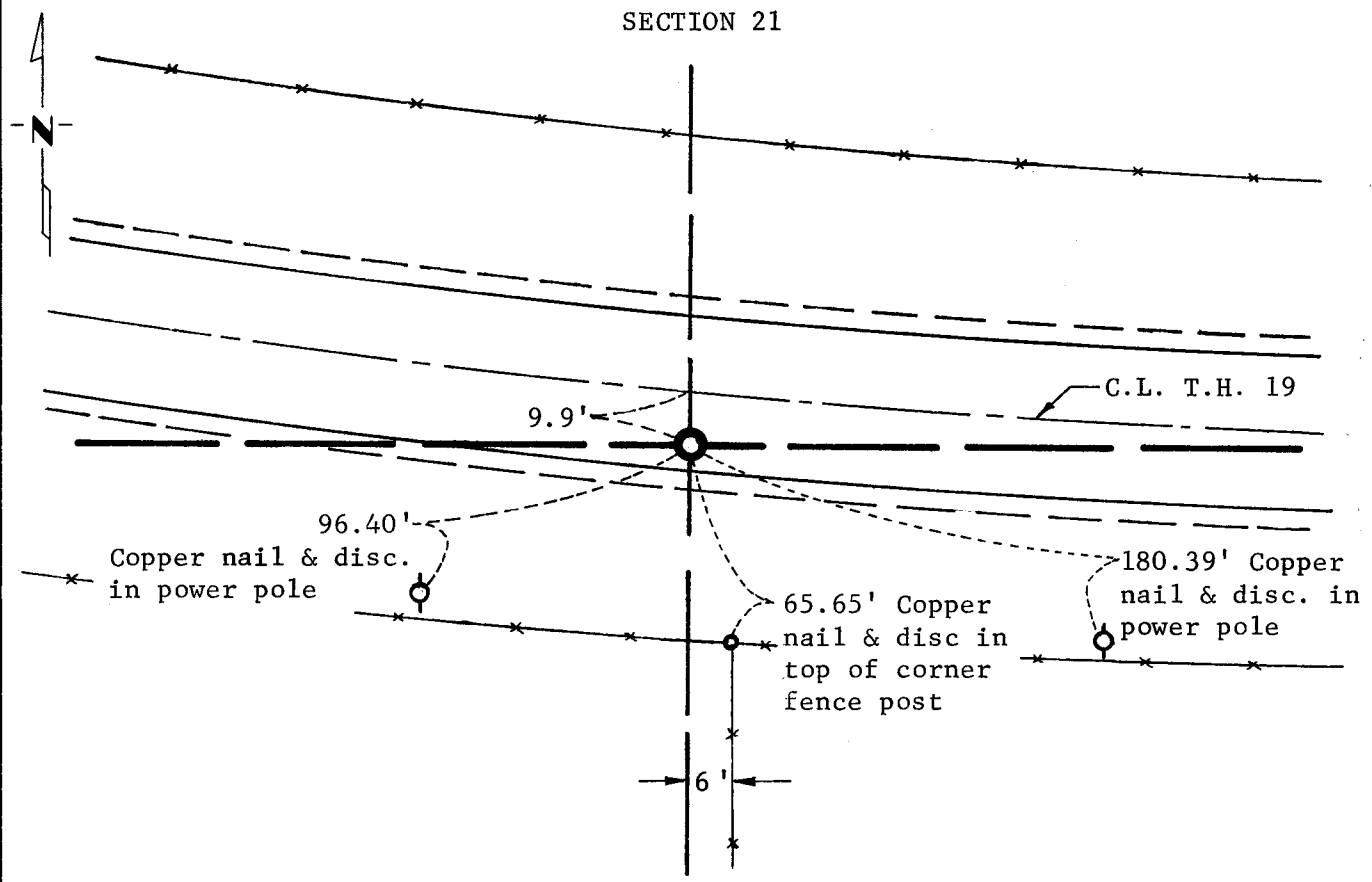

SECTION 28

Statement of evidence relative to this corner location is on back of page.

I hereby certify that this document and the data contained herein was prepared by me or under my direct supervision.

John E. Swenson 6-9-75
SIGNATURE DATE

Registration No. 10460

- Land Surveyor, Professional Engineer
- County Surveyor, County Engineer

OFFICE OF THE COUNTY RECORDER
County of Goodhue

I hereby certify that this document was filed in the Co. Recorders office at 4:20 P.M. on the 13 day of April A.D., 1977

County Recorder Craig A. Anderson
By _____, Deputy

DOCUMENT NO. _____